

SEGEDUNUM

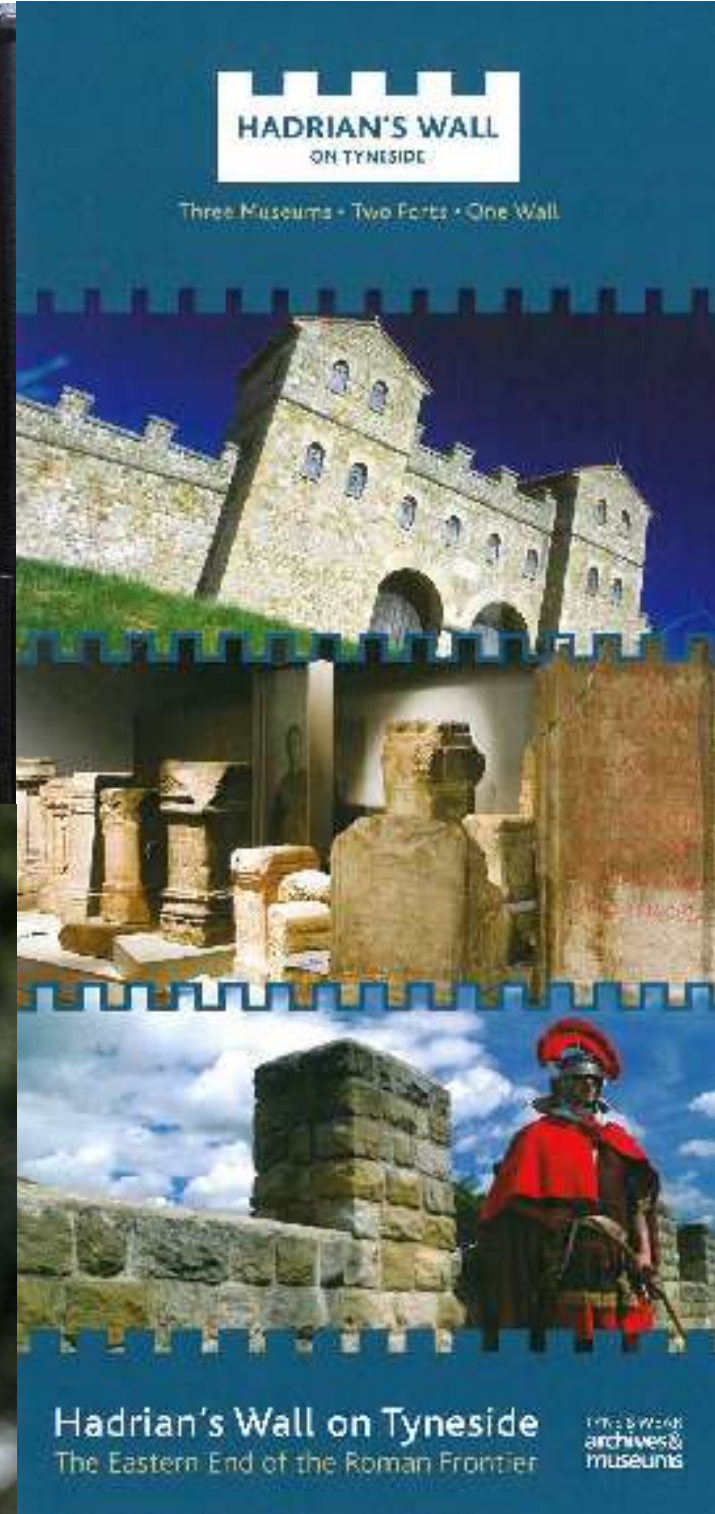

Sentius Tectonicus



Sentius Tectonicus – the new guard of Segedunum

Artist John O'Rourke was commissioned by North Tyneside Council to create the Centurion which is constructed from weathering steel and measures 2.8 high.

The contemporary sculpture links both the site's Roman heritage and its more recent industrial past.





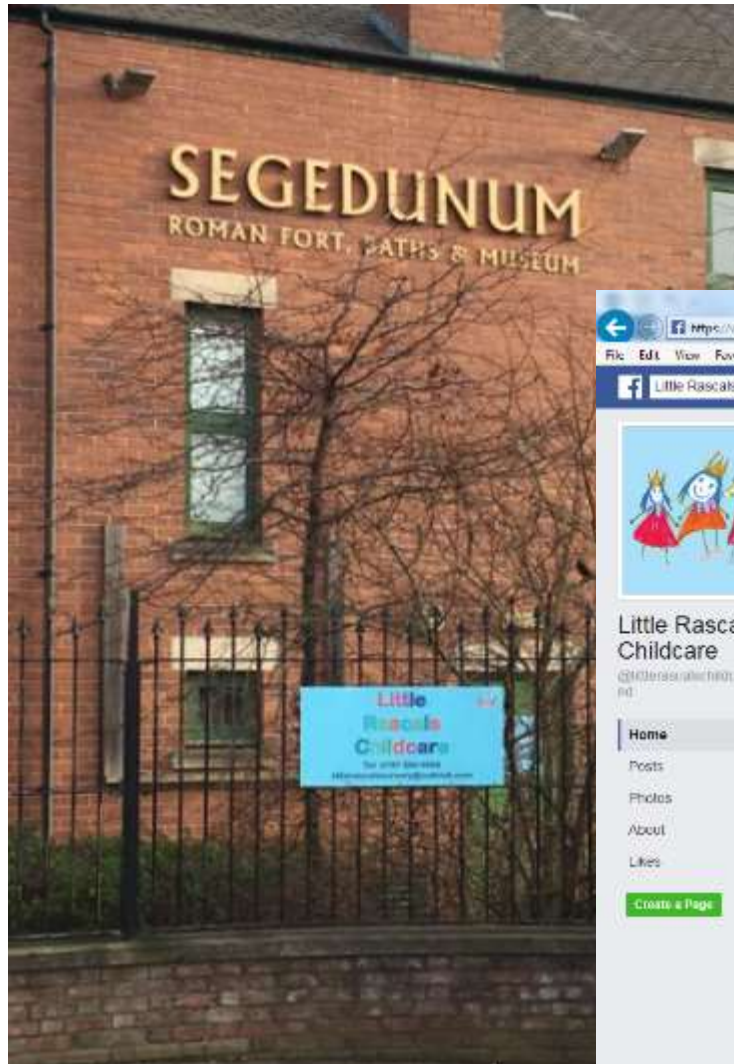

Little Rascals Childcare @ Segedunum Roman Fort, Baths & Museum

A screenshot of the Facebook page for Little Rascals Childcare. The page header shows the name 'Little Rascals Childcare' and the profile picture, which is a cartoon illustration of three children. The main content area features a post from November 20, 2016, with the text: 'Little Rascals Childcare added 5 new photos. Things starting to come together 😊'. Below this is a photo of a blue sign that says 'Little Rascals Childcare main entrance' with an arrow pointing right. To the right of the main post is an 'About' section with a map showing the location at 'Buckie Street, NE 20 6TH, Wallsend' and the phone number '0191 280 0000'. The page also shows a 'VISITOR POSTS' section with a '+2' icon and a 'Create a post' button.

A screenshot of a Facebook post from Little Rascals Childcare. The post text reads: 'Little Rascals Childcare added 4 new photos. Don't forget Little Rascals open days: Thursday 22nd and Friday 23rd 10.00am until 3pm. Come along and see our wonderful new settings! 😊'. Below the text is a large photo of a bright, modern nursery room with wooden floors, colorful furniture, and a red and white toy cart. There are also smaller thumbnail photos showing different areas of the nursery. The post has 5 likes and 2 comments.

A screenshot of a Facebook post from Little Rascals Childcare. The post text reads: 'Little Rascals Childcare added 4 new photos. Our new outdoor signs 😊'. Below the text is a large photo of a blue sign for 'Little Rascals Childcare' mounted on a black metal fence. There are also smaller thumbnail photos showing the sign in different locations. The post has 3 likes and 1 comment.

Segedunum

2016 - 17	
Visitors	49,065
Children in educational activities	9,154
Visitors	-6%
Schools	-8%
Retail	-7%
Events Talks Tours experiences	+438%
Facilitated Learning	+13%

Hadrian's Cavalry

The new **wall-wide exhibition** exploring the role and daily life of the Roman army's cavalry forces stretching the full 150 miles of the Hadrian's Wall World Heritage Site area – from Maryport in the west to South Shields in the east.



Hadrian's Cavalry

At Segedunum Hadrian's Cavalry features weapons and armour used on a daily basis and those used for the spectacular public displays.





Segedunum

Masterplan

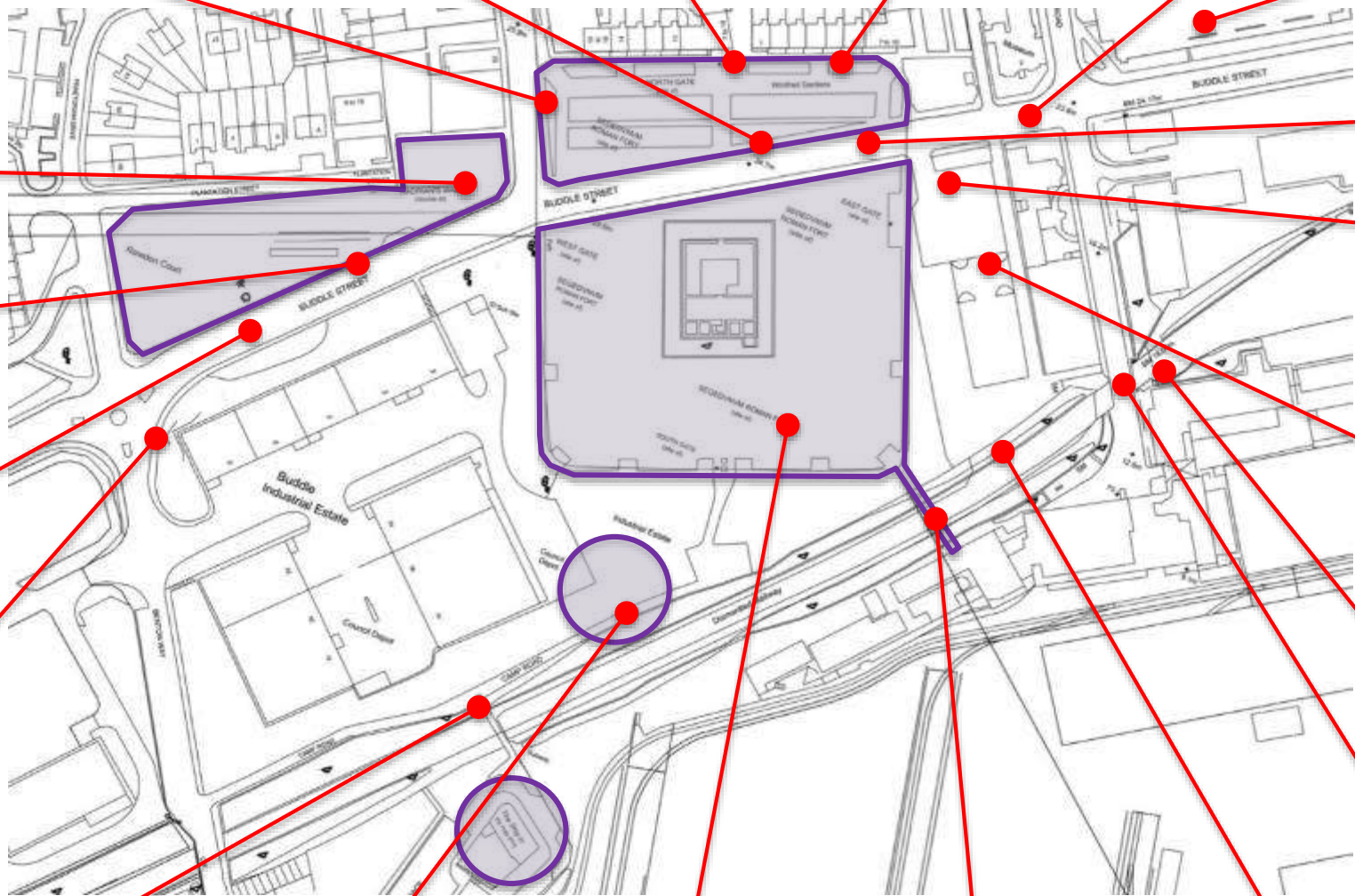



7. Photographic Survey: Sheet 2 : The Positives



- Herculaneum
- Pompeii
- Xanten
- Carnuntum
- Saarland





Proposed site boundary allows the management of hedgerow and tree cover to come under the direction of Tyne and Wear Museums.

Proposed site boundary includes Buddle Street shared surface treatments, to be appropriately managed by North Tyneside Council Highways team.

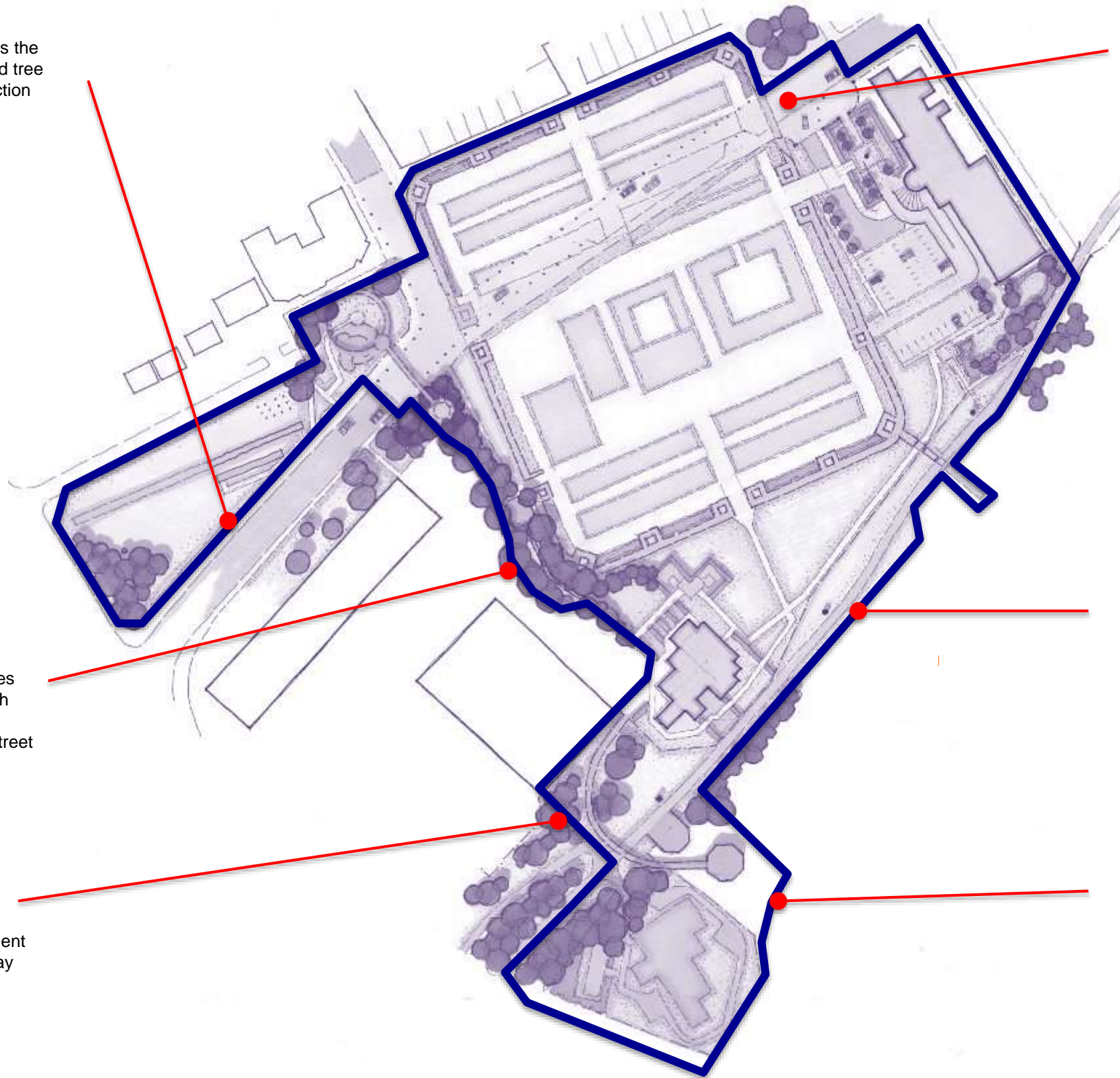

Proposed site boundary includes the small woodland edge, which can then be managed and footpaths, decks and Buddle Street access to be maintained appropriately

Proposed site boundary allows for close management and supervision of cycleway condition.

Proposed site boundary to be agreed with North Tyneside Council and to allow management of space beneath aerial walkway and deck to be appropriately managed for wildlife, and landscape benefit.

Proposed site boundary to be agreed with North Tyneside Council and to allow a degree of "future proofing" for ongoing site investigation and excavation.

We have prepared targeted investment plans that have been split into three categories:

1. Target investment 2015 – 2016 which illustrate the possible expenditure of the £500,000 HM Treasury Grant.
2. Medium term investment 2016 – Onwards which includes a whole range of possible improvements that could be made to enhance the visitor experience should the required funding be made available.
3. Major Infrastructure ideas that could only be carried out by North Tyneside Council if they wish to develop the site to match its true potential as a World Heritage Site.

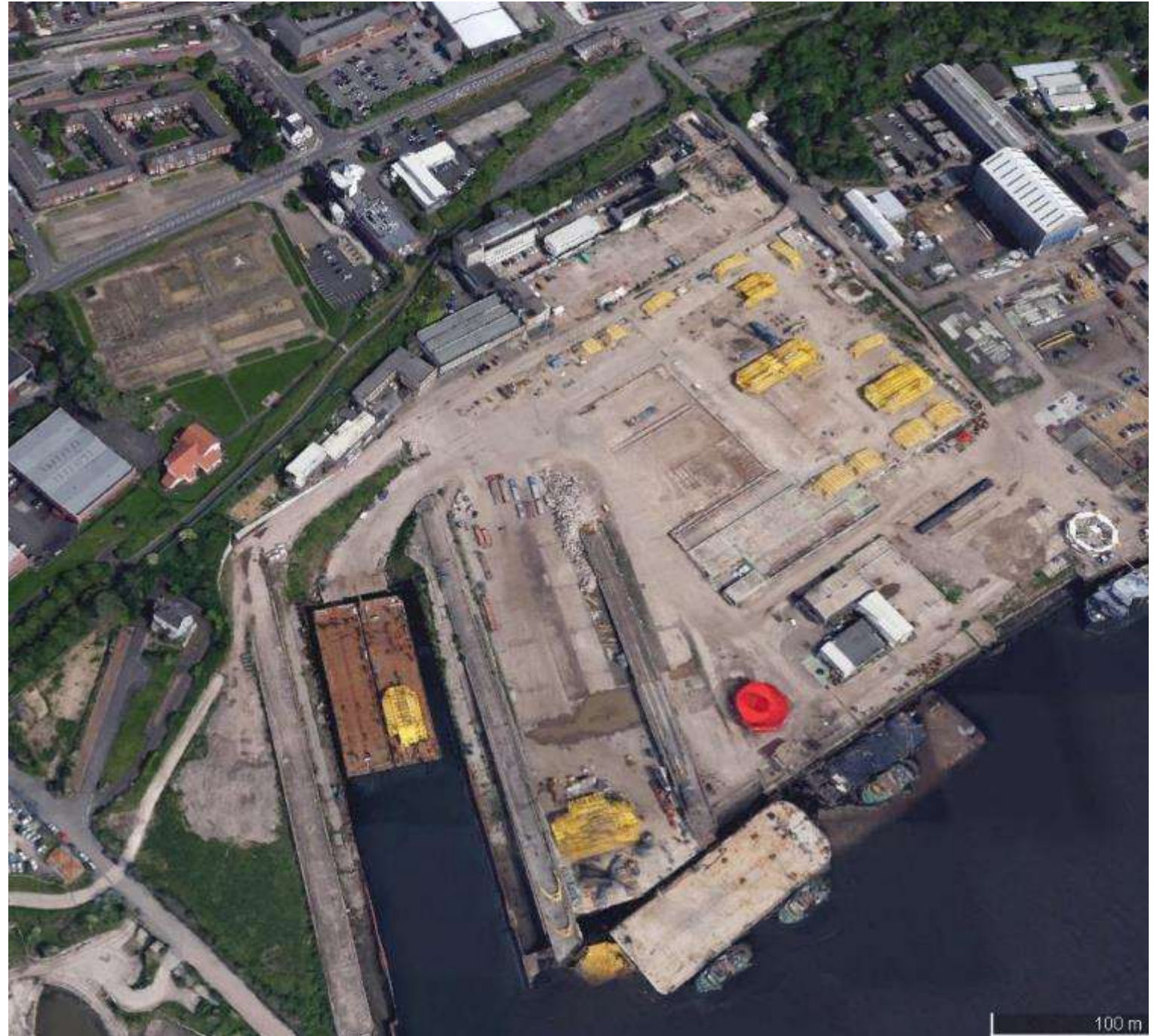

Consider improvements to West Wall and Wallsend B Pit area, to include improved elevated viewing deck areas, a recreation of the Vallum (possibly below same, and improved interpretation as part of a wider signage and way marking strategy.

Existing planting along Buddle Street that presently screens the wall reconstruction to be partly removed and in part managed in accordance with good horticultural / arboricultural practice, to enhance the setting of the wall and re-establish its presence on the main street.

Current hard landscape treatments across the fort site, to be refurbished, where practicable with surface treatments that will ensure colour contrast and low maintenance requirements for a minimum twenty year period. Consideration to be given to treatments similar to those used to north of Buddle Street.

Fly posting to railings to be removed, and a broader advertising and signage strategy for the entire site to be considered.

Internal railings between car park and fort area to be removed to "open up views of the attraction.

Consider the installation of a new themed play area/s in either location A (close to main museum building, or B in association with revised garden and picnic locations to both.

Open existing pedestrian entrance from the cycleway, at the same time as reconfiguring the perimeter security fencing to allow improved access to the Museum.

Trompe L'Oeil Identification of branch wall if physical route demarcation is not possible.

Existing "woodland" area to be appropriately managed to improve visual linkage between the main site and the west wall area.

Elevated sections of existing museum site to be further explored and enhanced to provide possible further viewing opportunities at greater elevation, interventions could include timber deck, platforms and railings, all with appropriate "Roman" detailing.

Vehicle access to be included as part of improved garden and picnic area site to the north of the Bath House reconstruction. Access could also be used for event access etc.

Remove existing picnic area which has no apparent setting or context, and relocate in a reconfigured Roman Garden area as part of the Bath House reconstruction.

Consider improvements to branch wall to re-establish its presence and significance. Include new pavement treatments both on and off site, to further demark the walls alignment, and continue on into the neighboring Swans regeneration where possible.

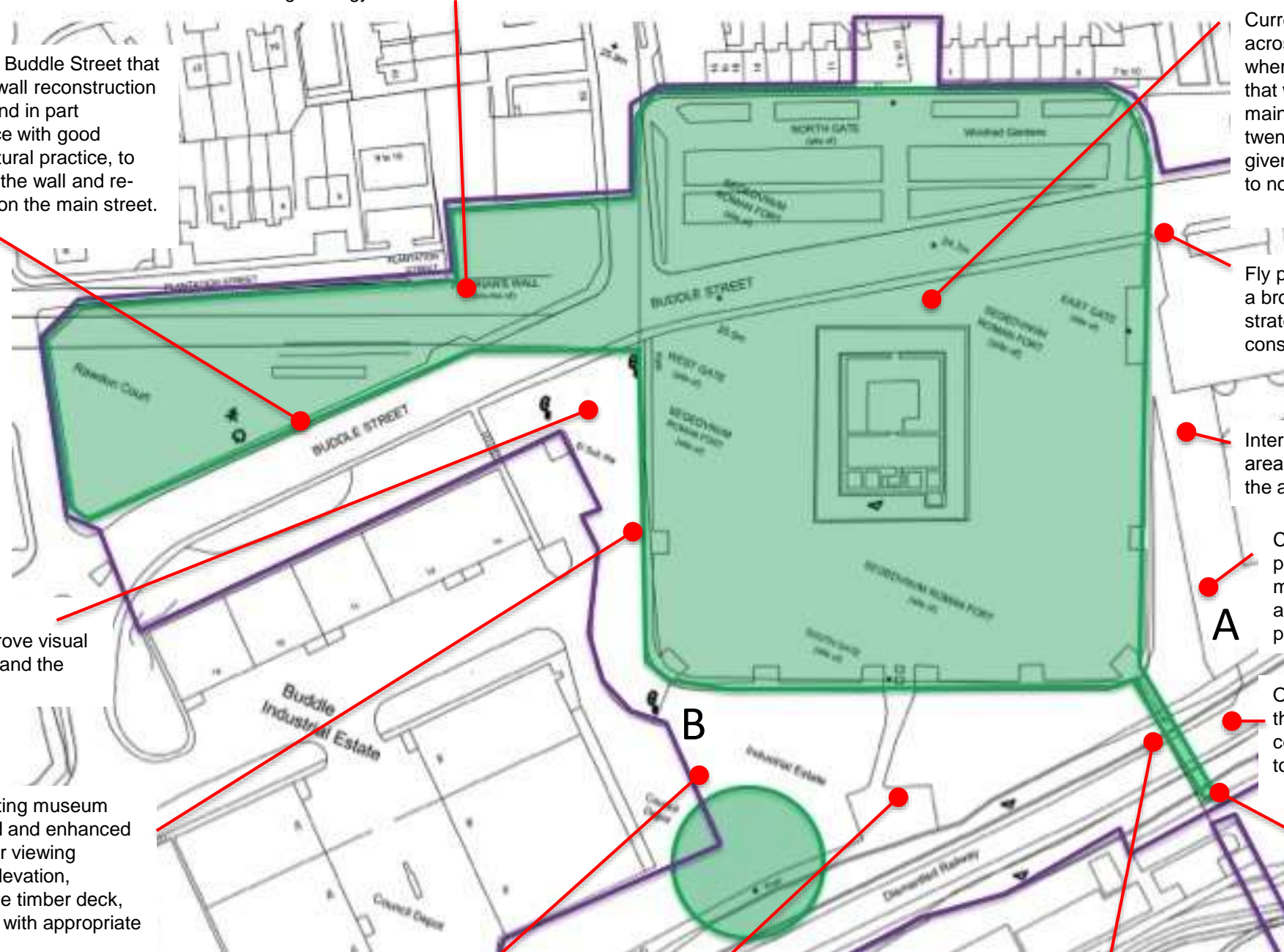

Potential location for significant artwork and signage interventions along Buddle Street, both here and east of the existing ASDA site.



Significant improvements to entrance area, including improved pedestrian movement and point of arrival, potentially using level changes to establish amphitheatre type entrance at the same time as maintaining DDA compliance. New soft landscape design to all approaches that reflects Romanesque plantings, to reaffirm the flavours of Roman Gardens rather than a contemporary intervention.

Car park to include shared surfacing throughout, a re-imagining of the coach turning area to improve permeability between Museum building and the ancient monument.

Consider off-site and layby coach parking to increase on-site capacity for cars.

Reappraise refuse and waste recycling storage etc.

Entrance "arena" may also include location for children's play area should this not be affordable in Phase 1 works.

Romanize tower with addition of symbolic crest to reinforce the urban myth that the tower design is based on a Roman helmet.

Proposed introduction of soft landscape elements to give a vertical interpretation of the extent of the original Fort site.

Similar interventions could be considered for buildings of significance throughout the estate.

Proposed high level suspended walkway and viewing platforms to link the main site with the recently discovered original Bath House.

Walkway terminates at a point several metres above the current excavations to manage access and to ensure DDA compliance for the attraction.

Significant improvements required to the Metro station, and should address relationship of North Gate to existing housing and which could mean demolition and regeneration of existing housing stock.

Improvements to hard landscaped thoroughfare, demolition of vacant units at the bus transfer area and a shared surface approach to the station.

Improved links to Metro and Bus hub.

Buddle Street to receive a full package of hard and soft landscape improvements, including a new shared surface throughout the area identified here, raising road to footpath level, and reflecting the extent of the fort across and throughout the paved surface.

Improvements should also include an updating of the street furniture, including new bollards and railings, both to have clear reference to Roman period design influence.

Emerging masterplan for the Swanhunter regeneration area should embrace the significance of the Branch Wall in any proposal, and further afield potentially at the waters edge.

Improved access to Swanhunter regeneration area, may take some traffic off Buddle Street?

North Tyneside Council may wish to consider an access only approach to traffic along this stretch of Buddle Street, upon completion of the new estate road currently underway as part of the Swanhunter regeneration.

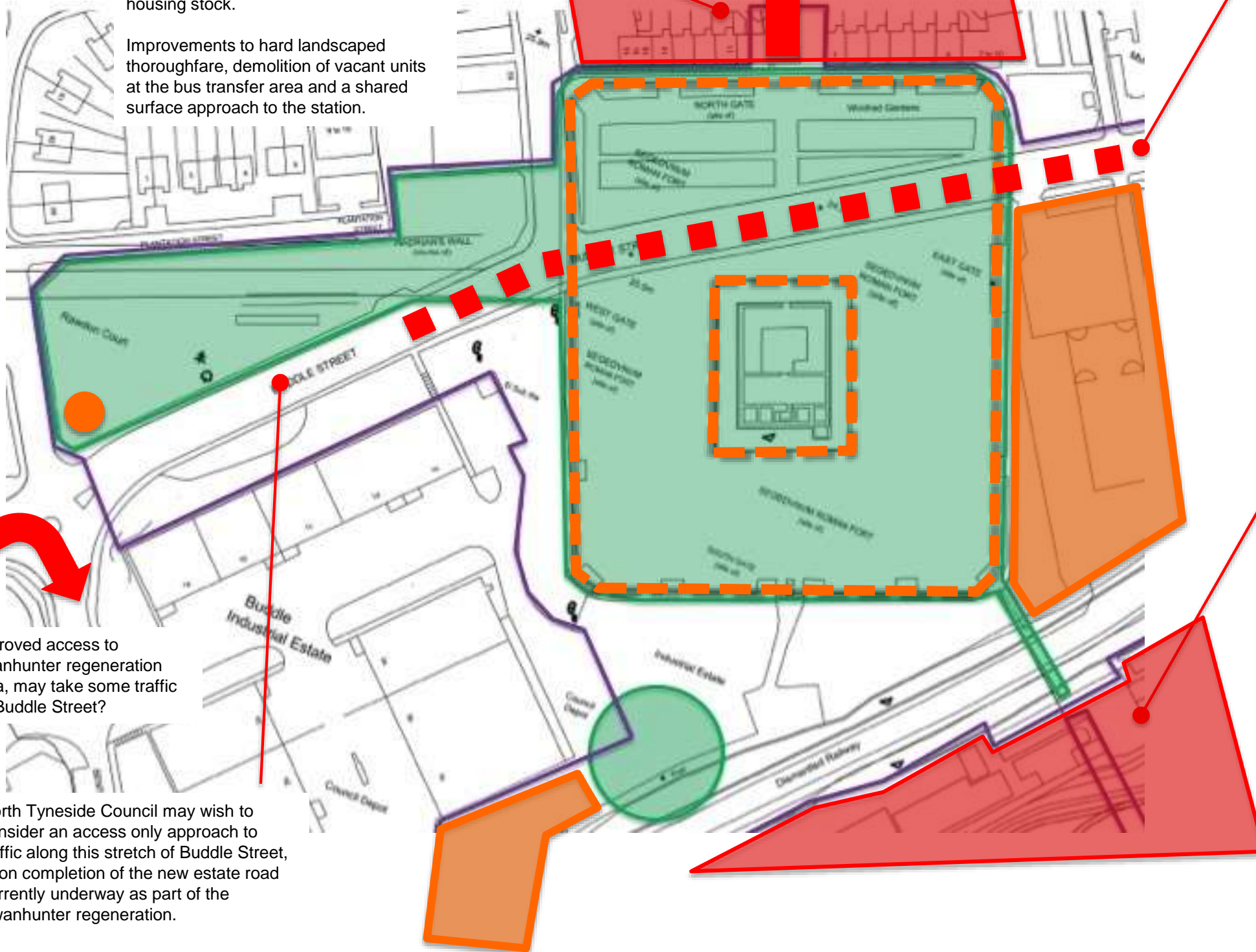



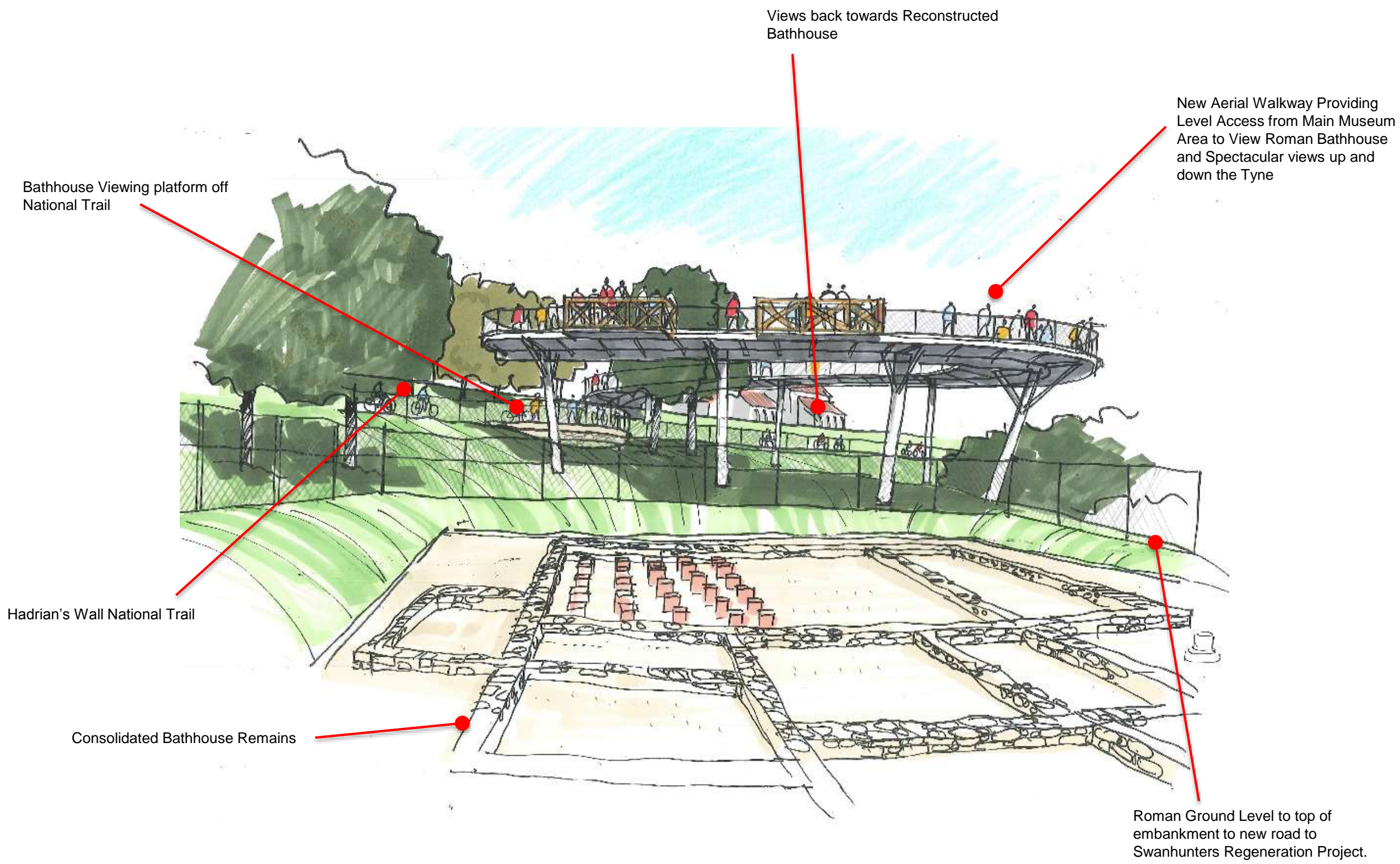

26. Medium Term Investment: Year 2016 – Onwards: Bathhouse Aerial Walkway

Interpretive display area, seating and rain shelter. Also provides privacy for adjacent dwellings

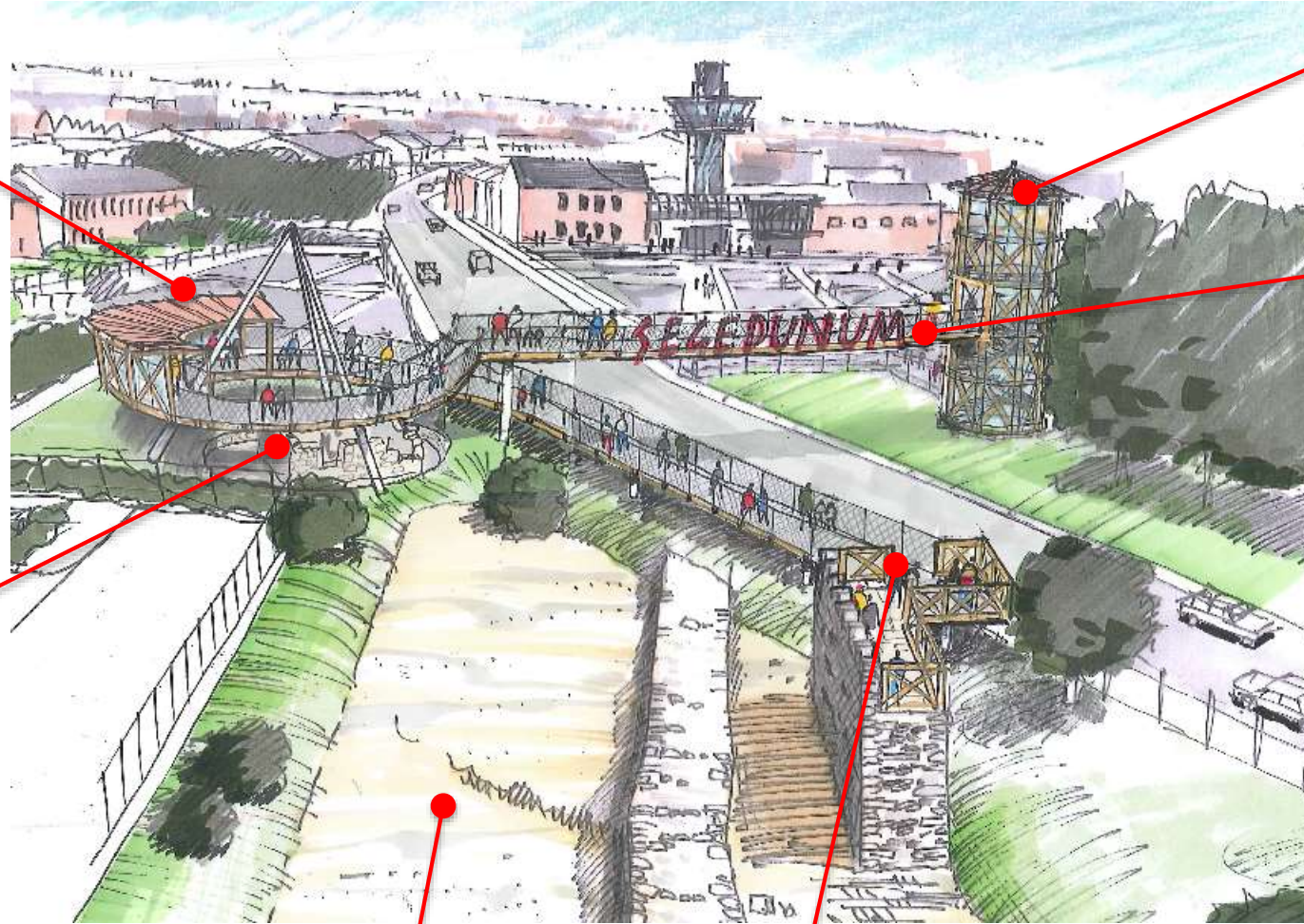

New staircase and lift tower to access aerial link and offer viewing opportunities over the site

New bridge link over Buddle Street. Also Provides opportunity to announce arrival at Segedunum

Remains of Ramp Wallsend "B" Pit visible from Spiral



Wall Defenses Display Area

New Aerial Walkway to connect with the top of the reconstructed wall to provide access for disabled visitors

Stunning display of consolidated remains of Collapse and Repair of Hadrian's Wall.



OVERALL TOTAL FOR ADDITIONAL MAIN SITE IMPROVEMENT WORKS 2017 -

Bath House Further Works	664,000
Main Site Further Works	2,817,000
Total (Exclusive of VAT)	3,481,000

TMA Architects: Architects

- Graham Tench
- Ces Maddison



PlaceonEarth: Landcape Architects

- Nick Wright
- Sietske Bourma



Thornton Firkin: Project Managers and Cost Consultants

- Richard Quigley
- Paul Reed



O-Design: Architectural Illustrator

- Edwin Onions



